

1st FLOOR

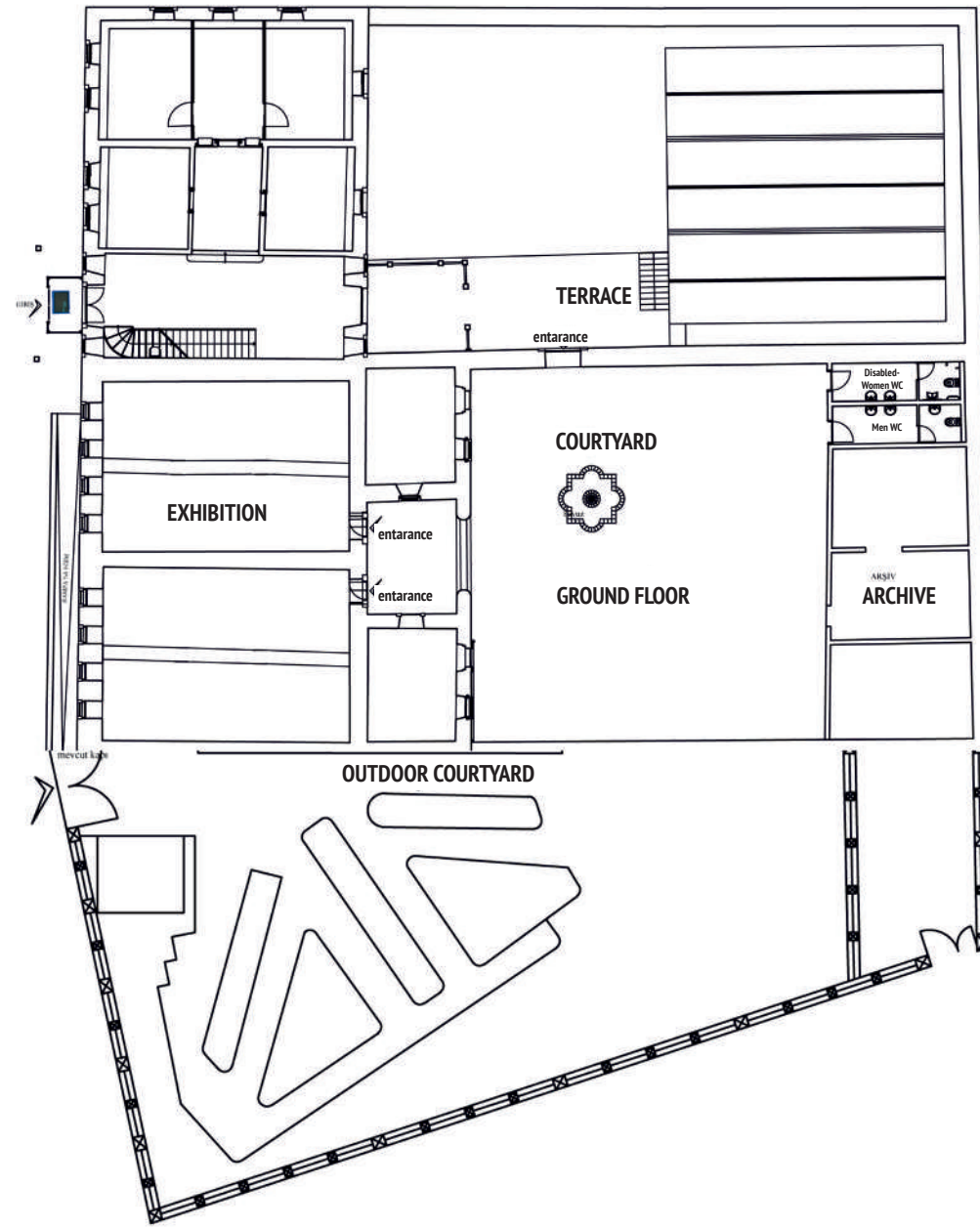

### Visiting Hours

Opening Time: 08:30  
Closing Time: 17:30  
Ticket Office Closing Time: 17:15

Open everyday.

Address: İstiklal Mahallesi Alınza Özkay Caddesi No: 25, Merkez/Bilecik

Please visit the web site for up-to-date information.

[f TurkishMuseums](#) [officialturkishmuseums](#) [TurkishMuseums](#) [TurkishMuseums](#) [TurkishMuseums](#)

[www.turkishmuseums.com](http://www.turkishmuseums.com)



[www.muze.gov.tr](http://www.muze.gov.tr)



GENERAL DIRECTORATE FOR  
CULTURAL ASSETS AND MUSEUMS

# BİLECİK MUSEUM

FOLLOW THE TRACES OF THE PAST

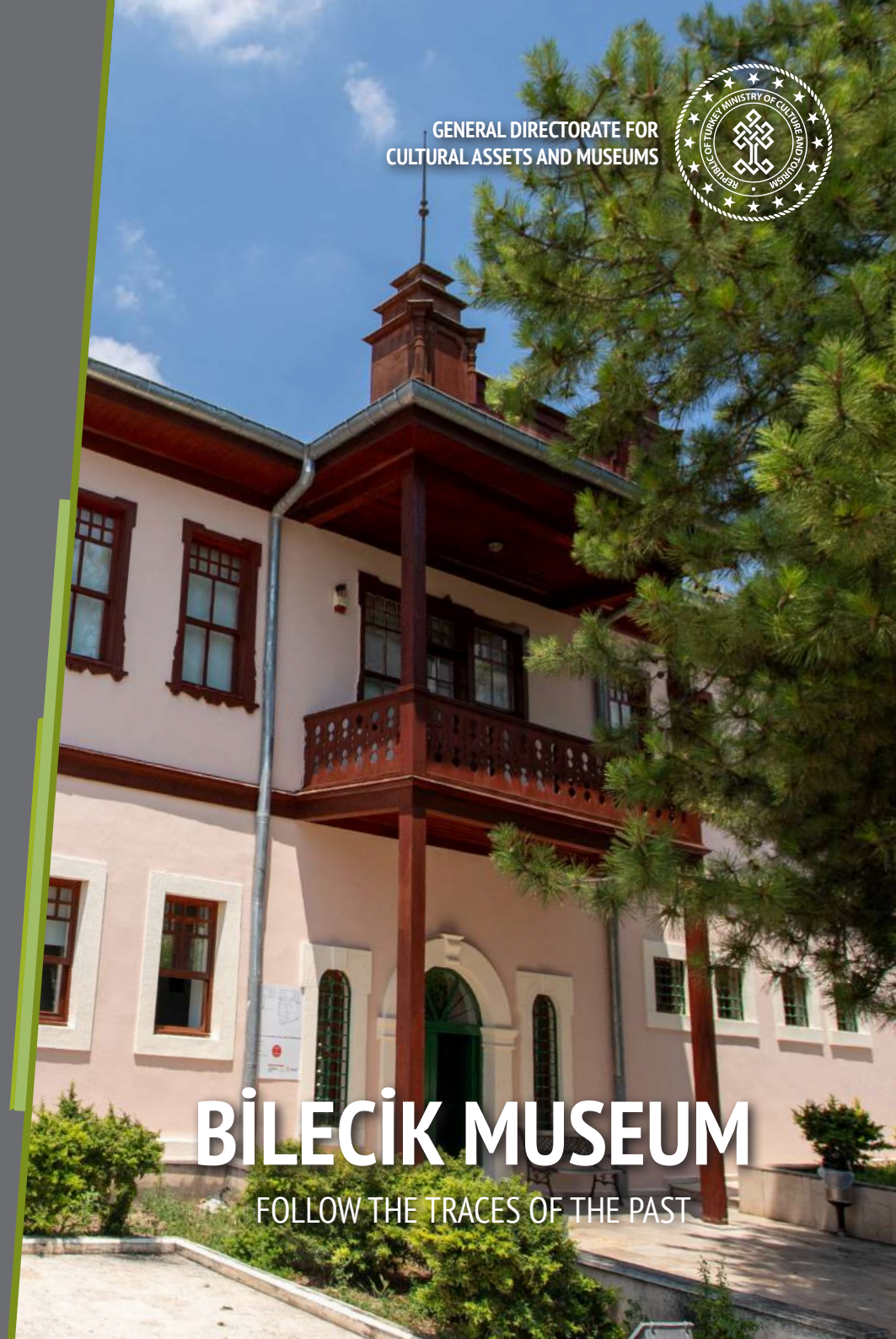



This building, now a museum, was erected in 1794 as a gendarmerie building. The ground floor of the two-story building was later used as a prison. During the Greek occupation in 1921-1922, the building burned down completely and was destroyed. After the War of Independence, it was rebuilt, with the upper floor being used as a courthouse and the ground floor as a prison for a time. This historic building, which was transferred to the Ministry of Culture and Tourism in 1996, has been hosting visitors who want to learn more about the history of the region since 2007 as Bilecik Museum.



Both archaeological and ethnographic artefacts are on display in the museum. In the archaeological exhibition halls, artifacts from the Neolithic, Chalcolithic, Bronze Age, Hellenistic, Roman and Byzantine periods can be seen, and in the ethnographic hall, descriptions of the founding of the Ottoman Empire, excerpts from the Oba and domestic life, tools of war, ceramics and glass artifacts are displayed.

