

İZNİK NİLÜFER HATUN IMARET TURKISH ISLAMIC ARTS MUSEUM PLAN

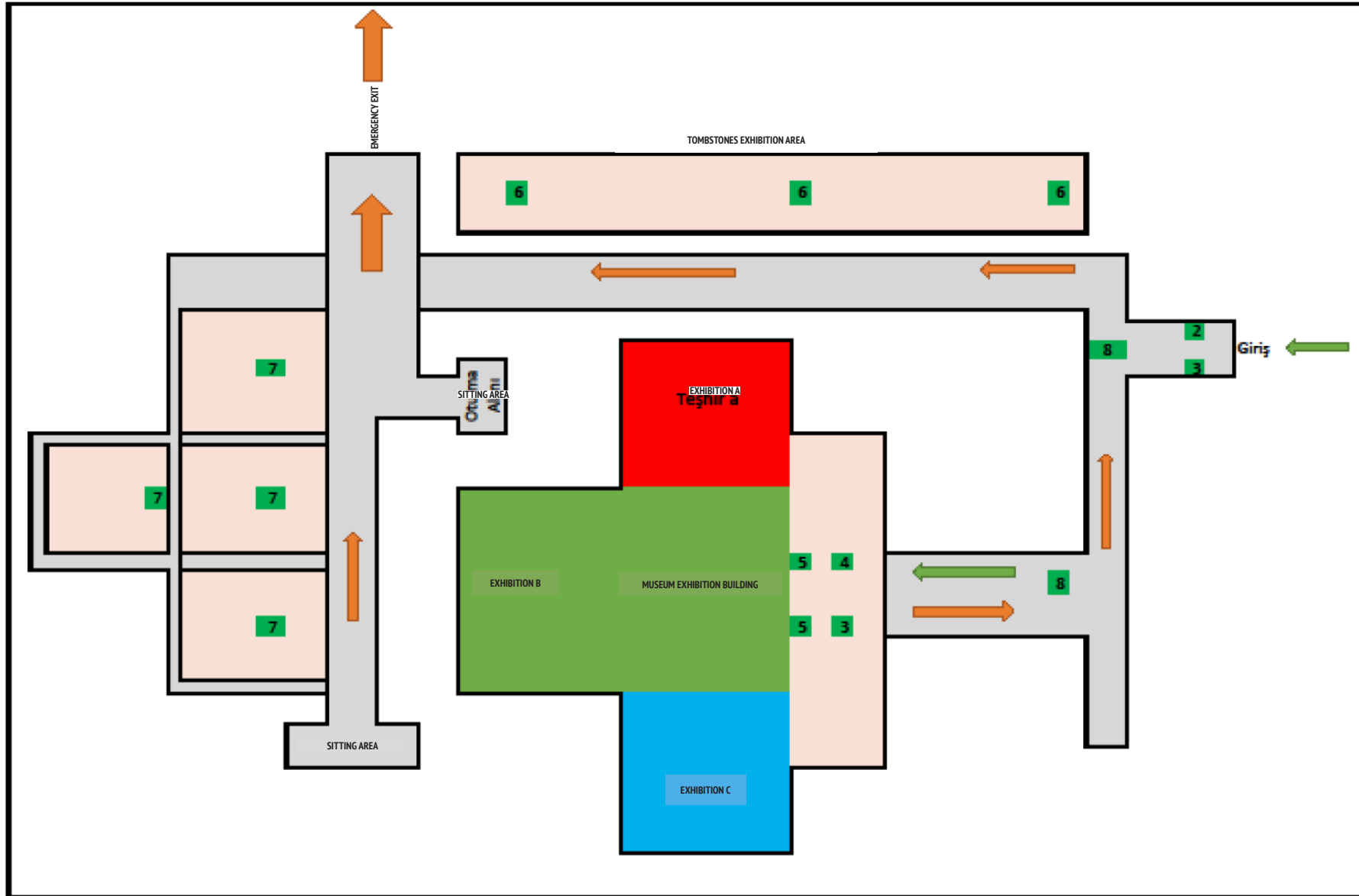

- 1-ENTRANCE
- 2-FEVER MEASUREMENT
- 3-DISINFECTANT
- 4-MASK WASTE BIN
- 5-SOCIAL DISTANCE
- 6-TOMBSTONES EXHIBITION
- 7-SACROPHAGUS EXHIBITION
- 8-WARNING SIGNS
- 9-EMERGENCY EXIT

NOTE: NO ARTEFACT STORAGE ROOM IS FOUND.



Visiting Hours

April 1 - October 31

Opening Time: 08:30
Closing Time: 19:00
Ticket Office Closing Time: 18:30

October 31 - April 1

Opening Time: 08:30
Closing Time: 17:00
Ticket Office Closing Time: 16:30

It is closed to visitors until 13.00 on the first day of religious holidays and on Mondays.

Address: Eşrefzade, Müze Sk.No:11, 16860 İznik/Bursa • **Phone:** 0224 757 10 27

Please visit the web site for up-to-date information.

[f TurkishMuseums](#) [officialturkishmuseums](#) [t TurkishMuseums](#) [y TurkishMuseums](#) [o TurkishMuseums](#)

www.turkishmuseums.com



www.muze.gov.tr



İZNİK NİLÜFER HATUN IMARET TURKISH ISLAMIC ARTS MUSEUM

TRACES OF OTTOMAN CULTURE IN İZNİK

GENERAL DIRECTORATE FOR
CULTURAL ASSETS AND MUSEUMS



Nilüfer Hatun
Imaret



Nilüfer Hatun Imaret, built by Sultan Murat I in memory of his mother Nilüfer Hatun (1362-1389) as an imaret and lodge, has an inverted T plan and is one of the early Ottoman Period examples. The building was put into service as a museum in 1960.

Tile Hall



In the Tile Hall section of the museum, the finest examples of tiles from architectural works are displayed alongside the Iznik tiles and pottery excavated during the Iznik Tile Kilns Excavation. There is also a section where the tile making and firing stages are animated.



Social Life,
Art and Trade
Hall

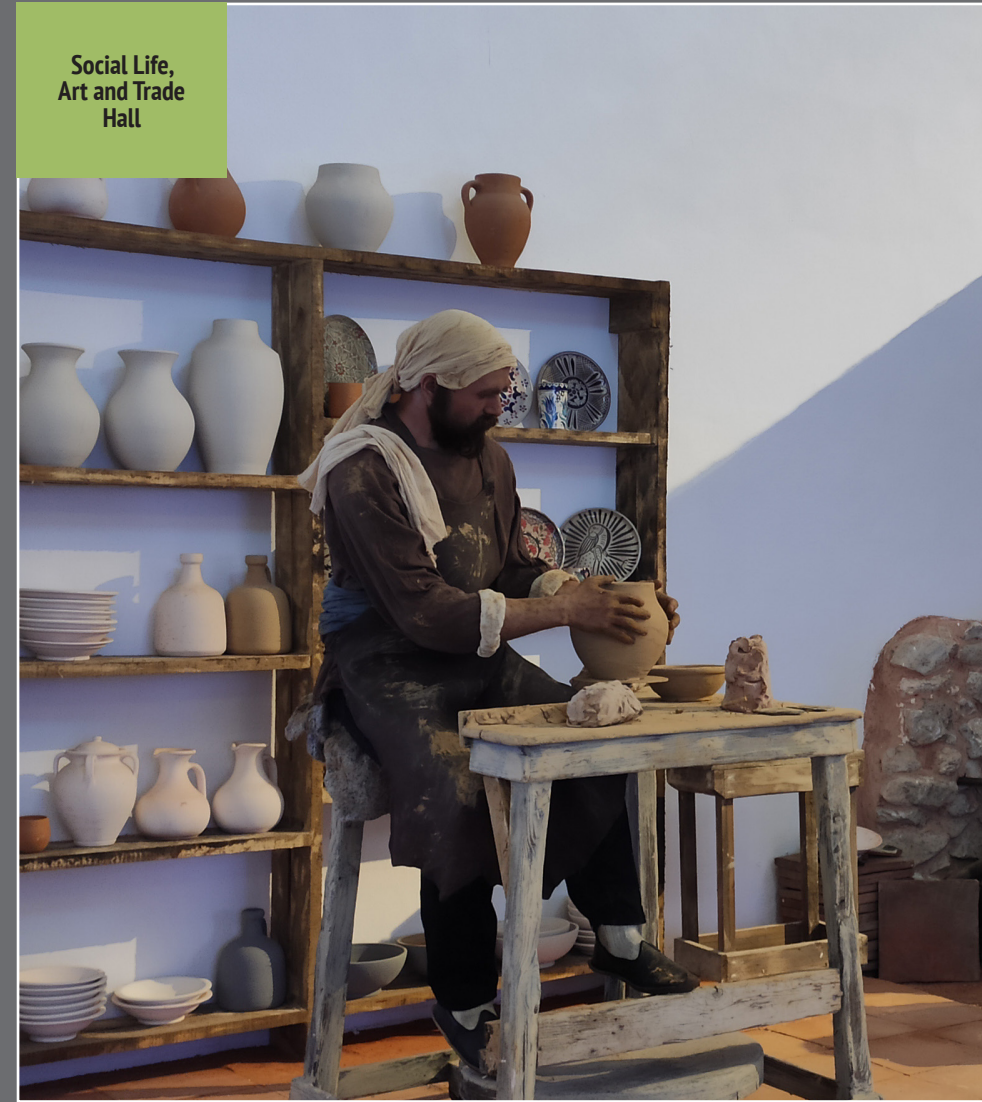

In the social life hall, coins belonging to the Umayyad, Abbasid, Great Seljuk, Anatolian Seljuk, Artuqid, Ilkhanid and Ottoman periods of Islamic culture are exhibited in two separate showcases consisting of gold, silver and bronze coins.

With the barbecue, coffee pan, mill and coffee pot used at every stage from the making to serving of coffee, which has a special place in Ottoman culture, The cup and cup holders in which the coffee is served are exhibited.

Apart from these, works reflecting Ottoman bath culture and calligraphy, calligraphy plates and inscriptions belonging to Early Period buildings are exhibited.

